

HFE100D, FLEXIBLE CABLE,
2.92(MALE)- GPPO(MINI-SMP)(FEMALE)

GAM8F71-292MGPPF-XXX

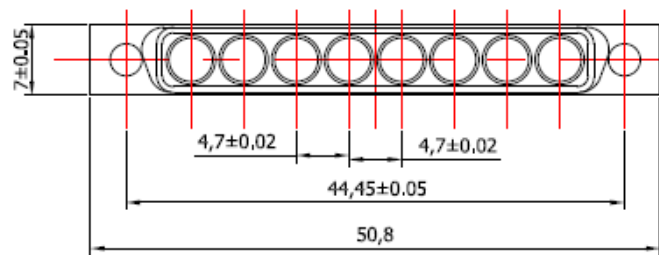
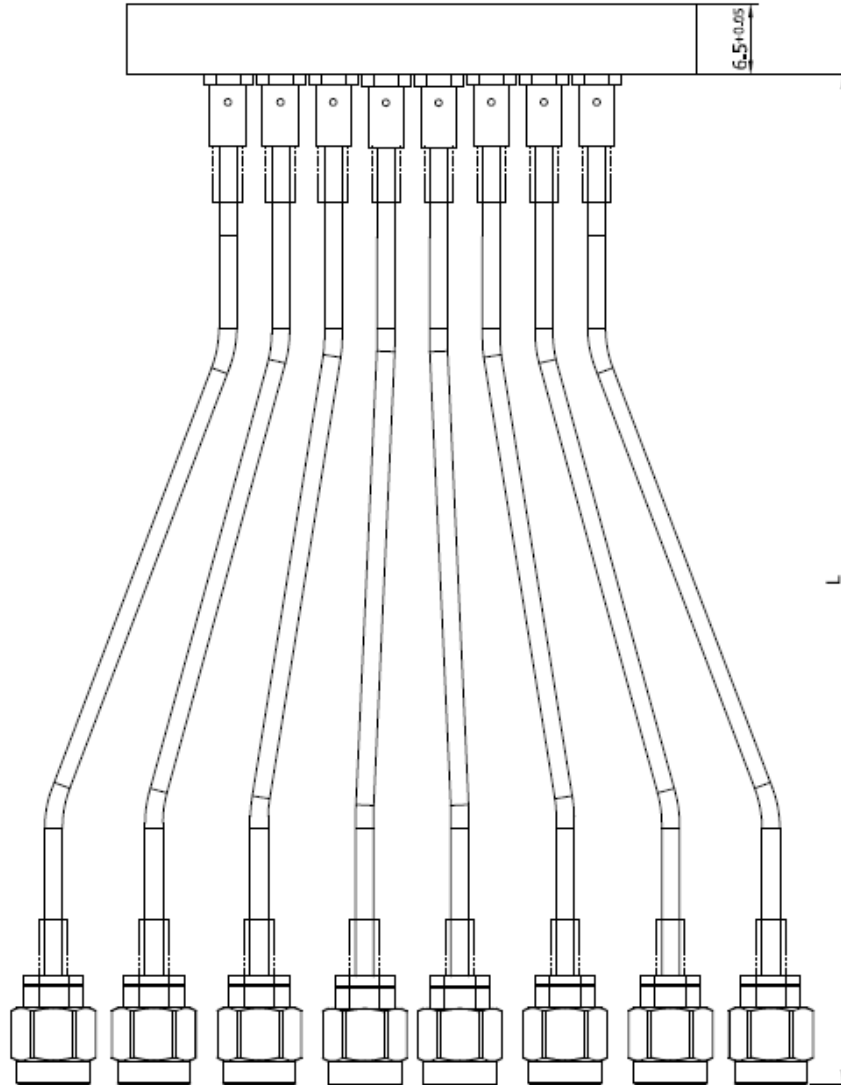

Configuration

Connector 1 Type	2.92 Male
Connector 1 Body Style	Straight
Body Material and Plating	Passivated Stainless Steel
Connector 1 Mount Method	None
Connector 2 Type	GPPO Female
Connector 2 Body Style	Straight
Body Material and Plating	CuBe Gold Plated
Connector 2 Mount Method	None
Housing	Brass Gold Plated
Cable Type	HFE100D

Electrical Specifications

Impedance	50 Ω
Frequency	DC to 40 GHz
Return Loss/VSWR	-14dB
Shielding Effectiveness	<-100dB @ 1GHz
Phase Matching	$\pm 30^\circ$ @40GHz Between 8 Pcs
Power Handling	110watt @ 2GHz at sea level,VSWR1.0

Environmental Data

Temperature Range	-40°C to +125°C
2002/95/EC(RoHS)	Compliant

Cable Specifications

Center Conductor	Silver plated copper
Dielectric	Solid PTFE
Jacket	FEP
Capacitance(pF/m)	96.1
Velocity of propagation(%)	70
Min. bending radius(mm)	6.35
Jacket Diameter(mm)	2.54 \pm 0.13

Part Number List

Part Number	Length [mm]	Insertion Loss ≤(dB)			
		5GHz	10GHz	20GHz	40GHz
GAM8F71-292MGPPF-1000	1000±10	1.7	2.5	3.8	6.9
GAM8F71-292MGPPF-800	800±8	1.4	2.06	3.14	5.66
GAM8F71-292MGPPF-600	600±6	1.09	1.64	2.48	4.32
GAM8F71-292MGPPF-500	500±5	0.95	1.42	2.15	3.82

While the information has been carefully compiled to the best of our knowledge, nothing is intended as representation or warranty on our part and no statement herein shall be construed as recommendation to infringe existing patents. In the effort to improve our products, we reserve the right to make changes judged to be necessary.